

Shoes

Part. 428 Product guide shoe

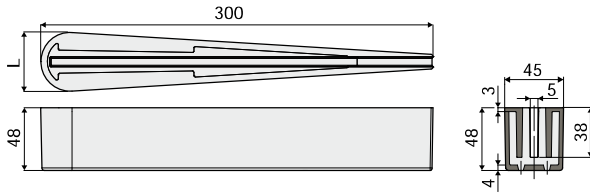

Type 1



L (mm)	Type 1 Code
45	428 / 85063



Type 2

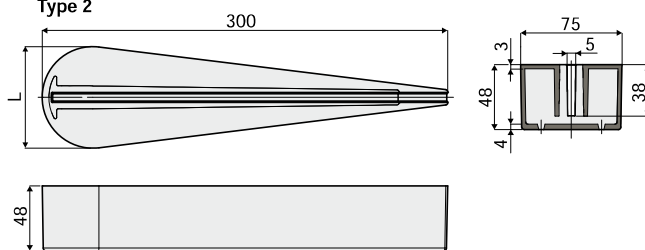

L (mm)	Type 2 Code
75	428 / 85064

MATERIALS: Internal part made of reinforced polypropylene, black colour; external covering in polyethylene, black colour.

FEATURES: To be used as product guide in the conveyor systems.

BOX QUANTITY: 12 pieces.

ON REQUEST:

- Box quantity: According to your request.

Example of application

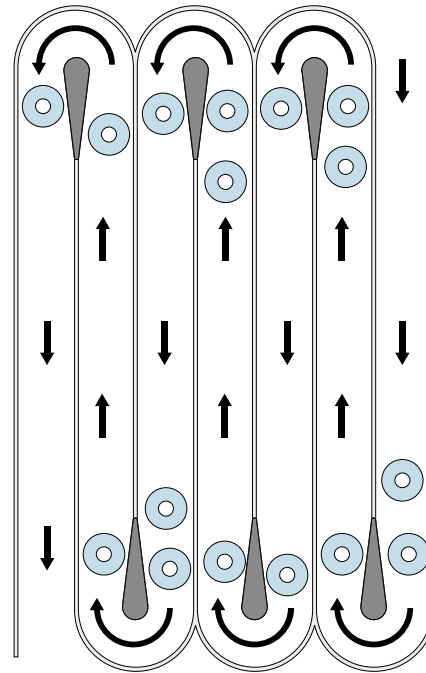

Example of application

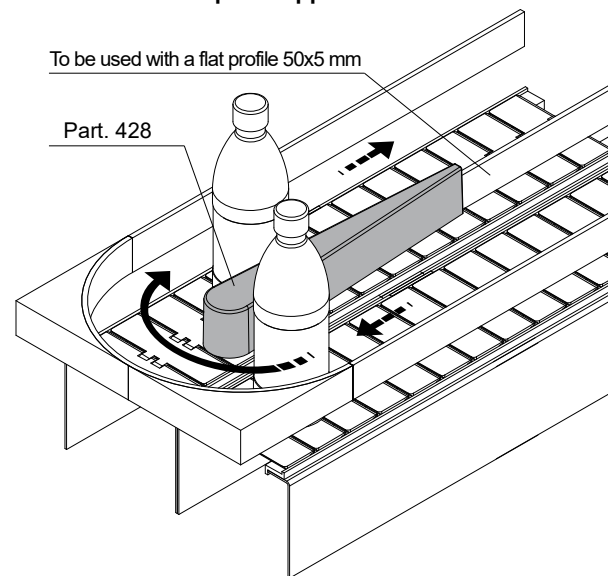

Shoes

Self-adjusting sliding shoe for chain return Part. 267

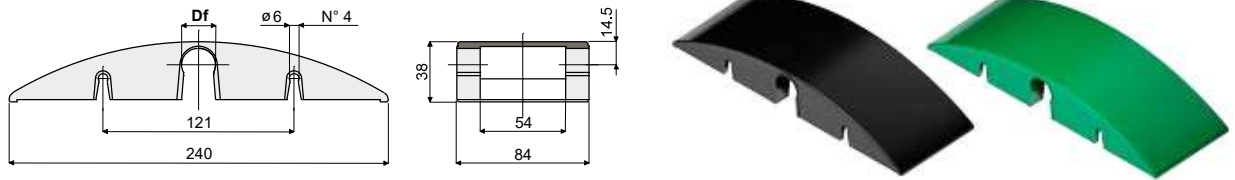

Df	Polyamide (black)	Polyethylene (green)
Bore for pin of (mm)	Code	Code
18	267 / 82038	267 / 82812
20	267 / 82039	267 / 82813

MATERIALS: Sliding shoe is made of polyamide black colour or of polyethylene green colour.

FEATURES: To be assembled in the chain return near to the sprocket. Snap-on assembly.

BOX QUANTITY: 12 pieces.

ON REQUEST:

- Sliding shoes: Other bore sizes, and colours.
- Box quantity: According to your request.

Shoe for chain return Part. 359 (for raised rib chains)

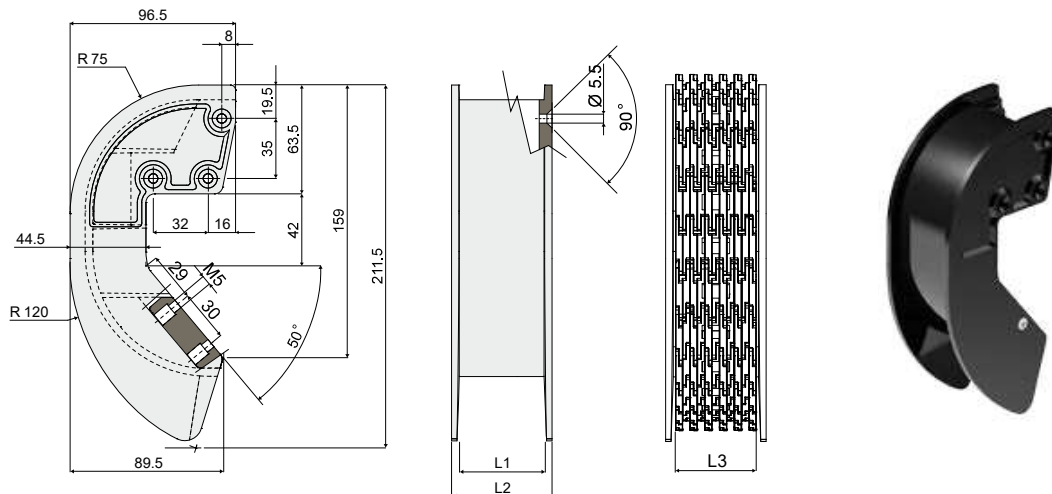

Code	L1	L2	L3 (Chain width)
359 / 83504	41	50	38,5
359 / 83503	49	58,5	47

MATERIALS: Shoe in black polyethylene; screws in stainless steel AISI 304.

FEATURES: Supplied complete with screws. To be used in the idler part of the conveyor.

BOX QUANTITY: 8 pieces.

ON REQUEST:

- Shoes: Other colours.
- Box quantity: According to your request.

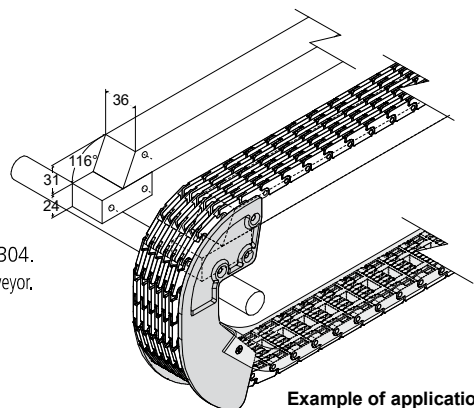

Example of application

Chain tensioners

Part. 277 Chain tensioner with sliding shoe (for roller chain type DIN 8187 08-B1 and 08-B2)

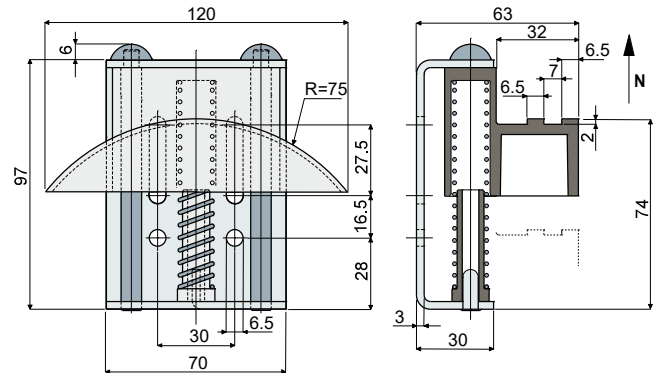

Code	Min. tension load (N)	Max. tension load (N)
277 / 82068	60	110

MATERIALS: External part, pin and spring are made of zinc plated steel; sliding shoe and spring guide are made of polyamide black colour.

FEATURES: To be assembled in the transmissions with roller chain to stretch it.

BOX QUANTITY: 12 pieces.

ON REQUEST:

- Sliding shoes: Different shapes for different chains, other materials and colours.
- Box quantity: According to your request.

Part. 278 Chain tensioner with sprocket (for roller chain type DIN 8187 08-B1)

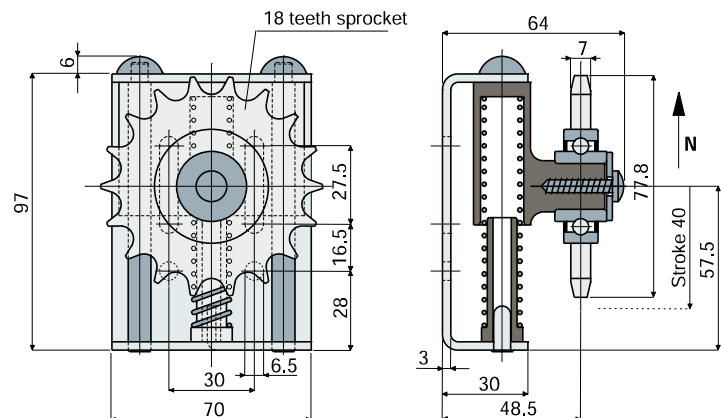

Code	Min. tension load (N)	Max. tension load (N)
278 / 82069	60	110

MATERIALS: External part, sprocket, pins and spring are made of zinc plated steel; cursor and spring guide are made of polyamide black colour.

FEATURES: To be assembled in the transmissions with roller chain to stretch it.

BOX QUANTITY: 12 pieces.

ON REQUEST:

- Sprockets: With other number of teeth.
- Box quantity: According to your request.

Bearing supports

Part. 300 Bearing-holder flange

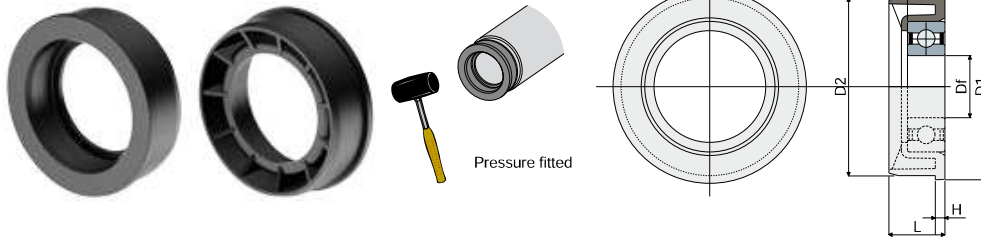

Tube dimensions			Bore for pin					Code	Bearing type
Outside ø (mm)	thickness (mm)	Inside ø (mm)	D1 (mm)	D2 (mm)	H (mm)	L (mm)	Df (mm)		
60	1,5	57,3	60	57,3	3	18	20	300 / 84814	6004/2RS
60	1,5	57,3	60	57,3	3	18	20	300 / 82682	Supplied without bearings
50	1,5	47	50	47,3	3	18	20	300 / 86727	6004/2RS
50	1,5	47	50	47,3	3	18	20	300 / 86728	Supplied without bearings

MATERIALS: Flange is made of polyamide black colour.

FEATURES: To be inserted in the tube sides D=60,3 thickness 1,5 mm to build a roller conveyor or rollers for chain return.

BOX QUANTITY: 24 pieces.

ON REQUEST:

- Flanges: Supplied assembled with bearings.
- Box quantity: According to your request.

Example of assembly

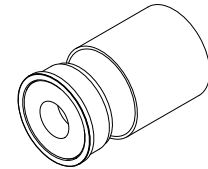

Part. 317 Bearing support for conveyor rollers (with protective shield)

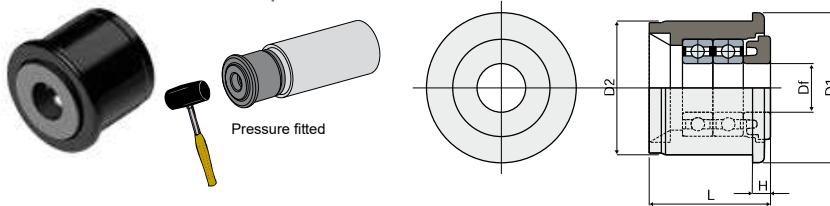

Tube dimensions			Bore for pin					Code	Bearing type
Outside ø (mm)	thickness (mm)	Inside ø (mm)	D1 (mm)	D2 (mm)	H (mm)	L (mm)	Df (mm)		
25	1,5	22	25	22	3	20	8	317 / 82911	688/8-2RS
25	1,5	22	25	22	3	20	8	317 / 82912	Supplied without bearings

MATERIALS: Bearing support with internal part and external bushing made of polyamide black colour; bearing made of chrome steel.

FEATURES: To be inserted in the tube sides to build a roller conveyor.

BOX QUANTITY: 24 pieces.

ON REQUEST:

- Bearing supports: Other colours.
- Box quantity: According to your request.

Part. 263 Bearing support for conveyor rollers (for idler roller)

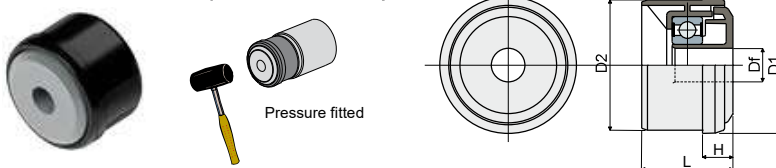

Tube dimensions			Bore for pin					Code	Bearing type
Outside ø (mm)	thickness (mm)	Inside ø (mm)	D1 (mm)	D2 (mm)	H (mm)	L (mm)	Df (mm)		
50	1,5	47	50	47	11	30	12	263 / 82032	6202-2RS
50	1,5	47	50	47	11	30	14	263 / 82256	6202-2RS
60	1,5	57	60	57	15	53	12	263 / 85071	6202-2RS
60	1,5	57	60	57	15	53	14	263 / 85068	6202-2RS
60	2	56	60	56	15	53	12	263 / 85072	6202-2RS
60	2	56	60	56	15	53	14	263 / 85069	6202-2RS
60	2,75	54,5	60	54,5	15	53	12	263 / 85073	6202-2RS
60	2,75	54,5	60	54,5	15	53	14	263 / 85070	6202-2RS

MATERIALS: Bearing support with protective shield made of polyamide grey colour; external bushing made of polyamide black colour; bearing made of chrome steel.

FEATURES: To be inserted in the tube sides to build a roller conveyor.

BOX QUANTITY: 24 pieces.

ON REQUEST:

- Bearing supports: Other colours, bores with different sizes.
- Box quantity: According to your request.

Example of assembly

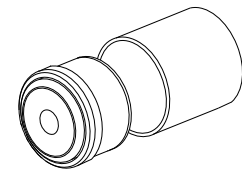

Bearing supports

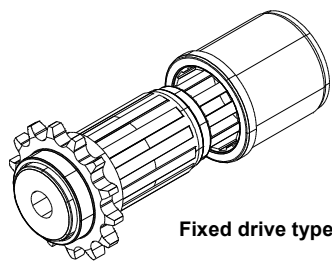

Fixed drive type

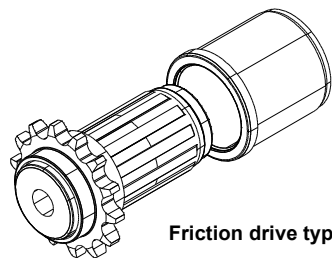

Friction drive type

Roller chain type DIN 8187 tipo 08-B1

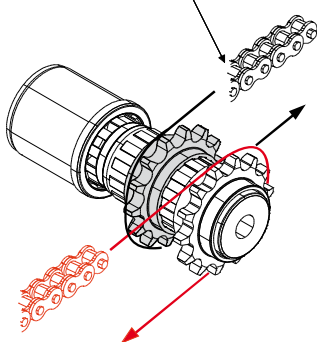

Example of assembly

14 teeth bearing support for conveyor rollers (for drive roller)

Part. **264**

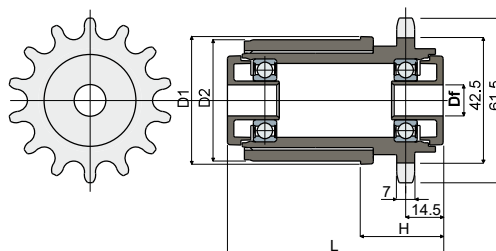

Tube dimensions			Bore for pin					Fixed drive type	Friction drive type	Bearing type
Outside ϕ (mm)	Thickness (mm)	Inside ϕ (mm)	D1 (mm)	D2 (mm)	H (mm)	L (mm)	Df (mm)	Code	Code	
50	1,5	47	50	47	32	83	12	264 / 82033	264 / 82217	6002-2RS
50	1,5	47	50	47	32	83	14	264 / 82215	264 / 82218	6002-2RS
60	1,5	57	60	57	39	83	12	264 / 85074	264 / 84244	6002-2RS
60	1,5	57	60	57	39	83	14	264 / 85075	264 / 84245	6002-2RS
60	2	56	60	56	39	83	12	264 / 85076	264 / 84246	6002-2RS
60	2	56	60	56	39	83	14	264 / 85077	264 / 84247	6002-2RS
60	2,75	54,5	60	54,5	39	83	12	264 / 85078	264 / 84251	6002-2RS
60	2,75	54,5	60	54,5	39	83	14	264 / 85079	264 / 84253	6002-2RS

MATERIALS: Bearing support with protective shield made of polyamide grey colour; external bushing made of polyamide black colour; bearing made of chrome steel.

FEATURES: To be inserted in the tube sides to build a roller conveyor. Drive sprocket with 14 teeth for roller chain type DIN 8187-08-b1.

BOX QUANTITY: 24 pieces.

ON REQUEST:

- Bearing supports: other colours, bores with different sizes.
- Box quantity: According to your request.

14 teeth sprocket Part. **265** (for bearing support Part. 264)

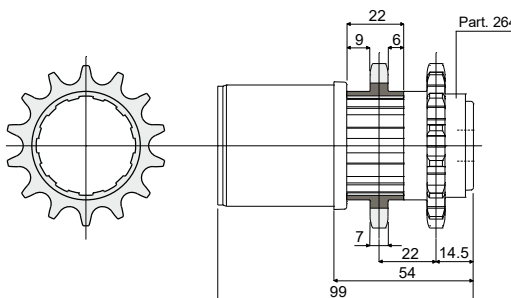

Code
265 / 82034

MATERIALS: Drive sprocket is made of polyamide black colour.

FEATURES: Accessory to be used with bearing support Part.264 to make the drive roller to roller. This drive type allows a greater torque.

BOX QUANTITY: 24 pieces.

ON REQUEST:

- Sprockets: other colours.
- Box quantity: According to your request.

Bushings

Threaded bushings (for conveyor flanks)

Part. **336**

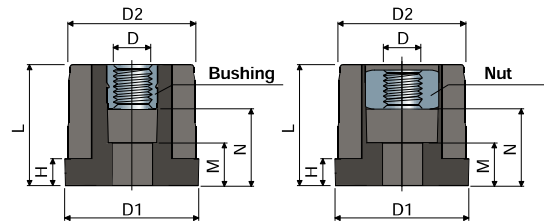

Tube dimensions										With bushing
Outside (mm)	Thickness (mm)	Inside (mm)	Thread D	D1 (mm)	D2 (mm)	H (mm)	L (mm)	M (mm)	N (mm)	Code
20x20	1,5	17x17	M8	20x20	17x17	5	28	13	18	336 / 83138

Tube dimensions										With nut
Outside (mm)	Thickness (mm)	Inside (mm)	Thread D	D1 (mm)	D2 (mm)	H (mm)	L (mm)	M (mm)	N (mm)	Code
20x20	1,5	17x17	M8	20x20	17x17	5	28	13	18	336 / 84563

MATERIALS: Bushing in reinforced polyamide black colour; threaded insert or nut in nickel plated brass.

FEATURES: Supplied assembled. To be assembled in the conveyor flanks.

BOX QUANTITY: 48 pieces.

ON REQUEST:

- Bushes: Special thickness tube.
- Box quantity: According to your request.

Example of application

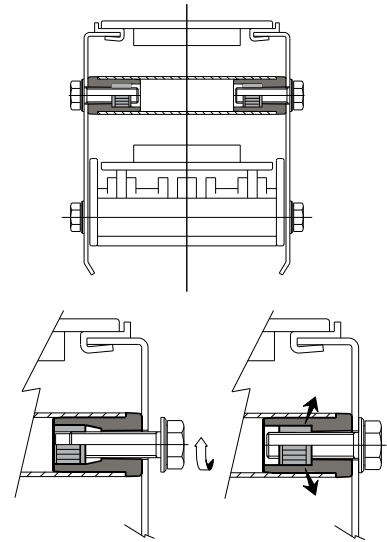

Part. **335** Threaded bushings (for conveyor flanks)

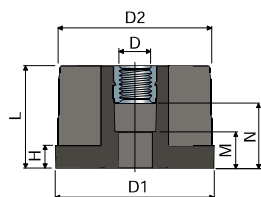
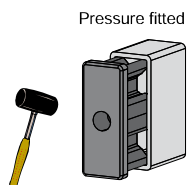

Tube dimensions										Code
Outside (mm)	Thickness (mm)	Inside (mm)	Thread D	D1 (mm)	D2 (mm)	H (mm)	L (mm)	M (mm)	N (mm)	Code
20x50	2	16x46	M8	20x50	16x46	5	28	13	18	335 / 83128

MATERIALS: Bush in reinforced polyamide black colour; threaded insert in nickel plated brass.

FEATURES: Supplied assembled. To be assembled in the conveyor flanks.

BOX QUANTITY: 48 pieces.

ON REQUEST:

- Bushes: Special thickness tube.
- Box quantity: According to your request.

Example of application

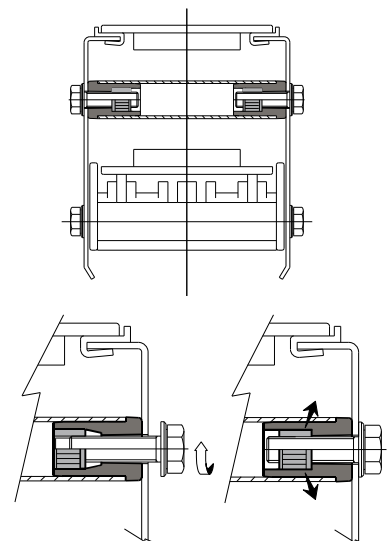

Process control

Scanning lever

Part. **360**

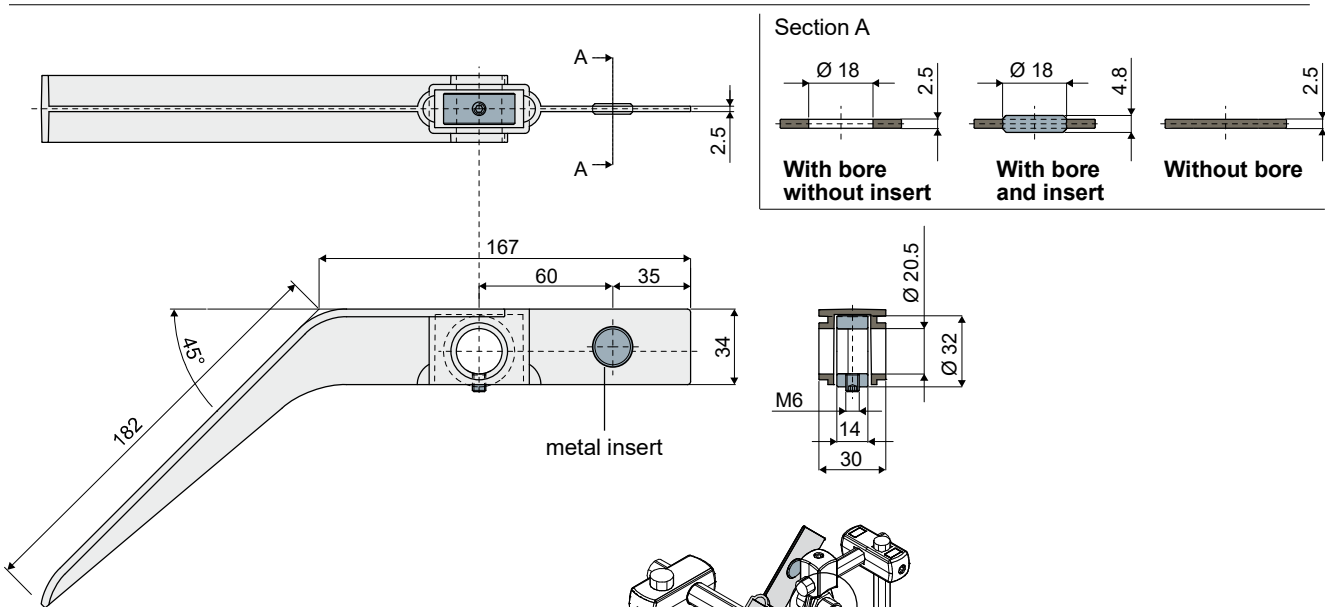

Stop ring in zinc plated steel		
Without bore	With bore without sensor insert	With bore and sensor insert
Code	Code	Code
360 / 83606	360 / 83607	360 / 83608

Stop ring in stainless steel AISI 304		
Without bore	With bore without sensor insert	With bore and sensor insert
Code	Code	Code
360 / 84091	360 / 85184	360 / 85185

MATERIALS: Scanning lever in reinforced polyamide black colour; grain and collar in zinc-plated steel or stainless steel AISI 304.

FEATURES: Supplied assembled. To be used in the surveying of the packaged products.

BOX QUANTITY: 24 pieces.

ON REQUEST:

- **Scanning levers:** Versions without stop ring nor sensor insert; in different colours.
- **Box quantity:** According to your request.

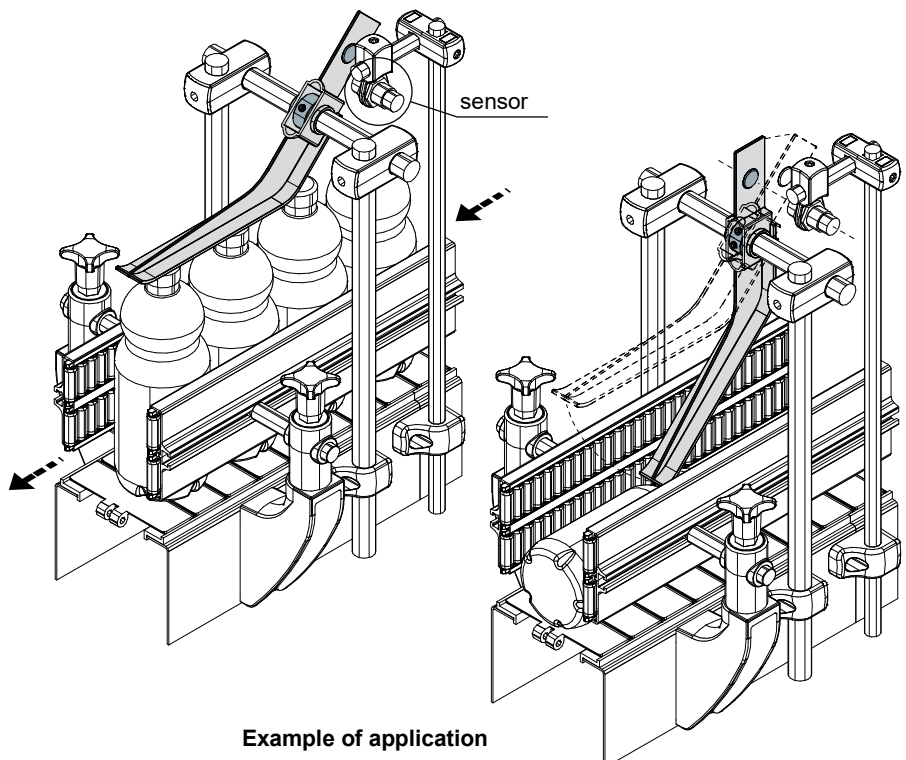

Example of application

Accessories for the cross adjustment of the side guides

Part. 429 Spacer (for conveyors' section)

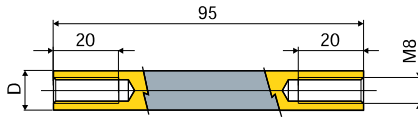

D (mm)	Code
12	429 / 85065
16	429 / 85066

MATERIALS: Spacers in Stainless steel AISI 304.

FEATURES: To be used to fix the frame in the conveyor system.

BOX QUANTITY: 24 pieces.

ON REQUEST:

- Box quantity: According to your request.

Example of application

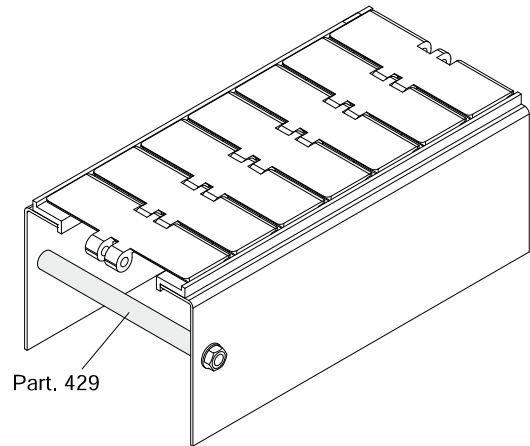

Part. 429

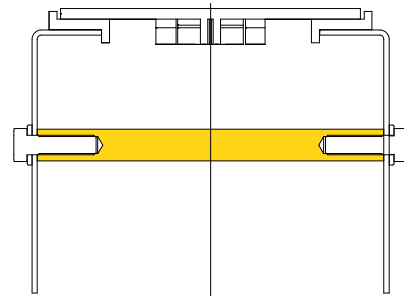

Part. 316 Spacer for rail-holder cylinder

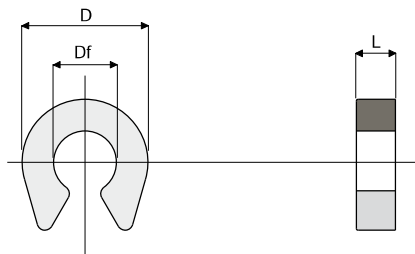

Df Bore diameter (mm)	D (mm)	L (mm)	Code
8	16	2,5	316 / 82871
8	16	5	316 / 82872

MATERIALS: Spacer made of polyamide black colour.

FEATURES: To be used as spacer for the stroke regulation of rail-holder pneumatic cylinder. Snap-on assembly on 8 mm diameter spindles.

BOX QUANTITY: 96 pieces.

ON REQUEST:

- Spacers: With special bores and sizes.
- Box quantity: According to your request.

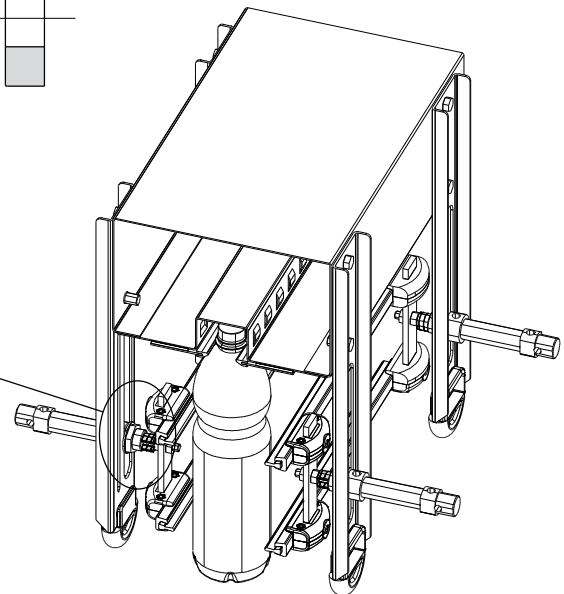

Example of application

Accessories for the cross adjustment of the side guides

Reducer for Racks

(for the cross adjustment of the side guides)

Part. **299**

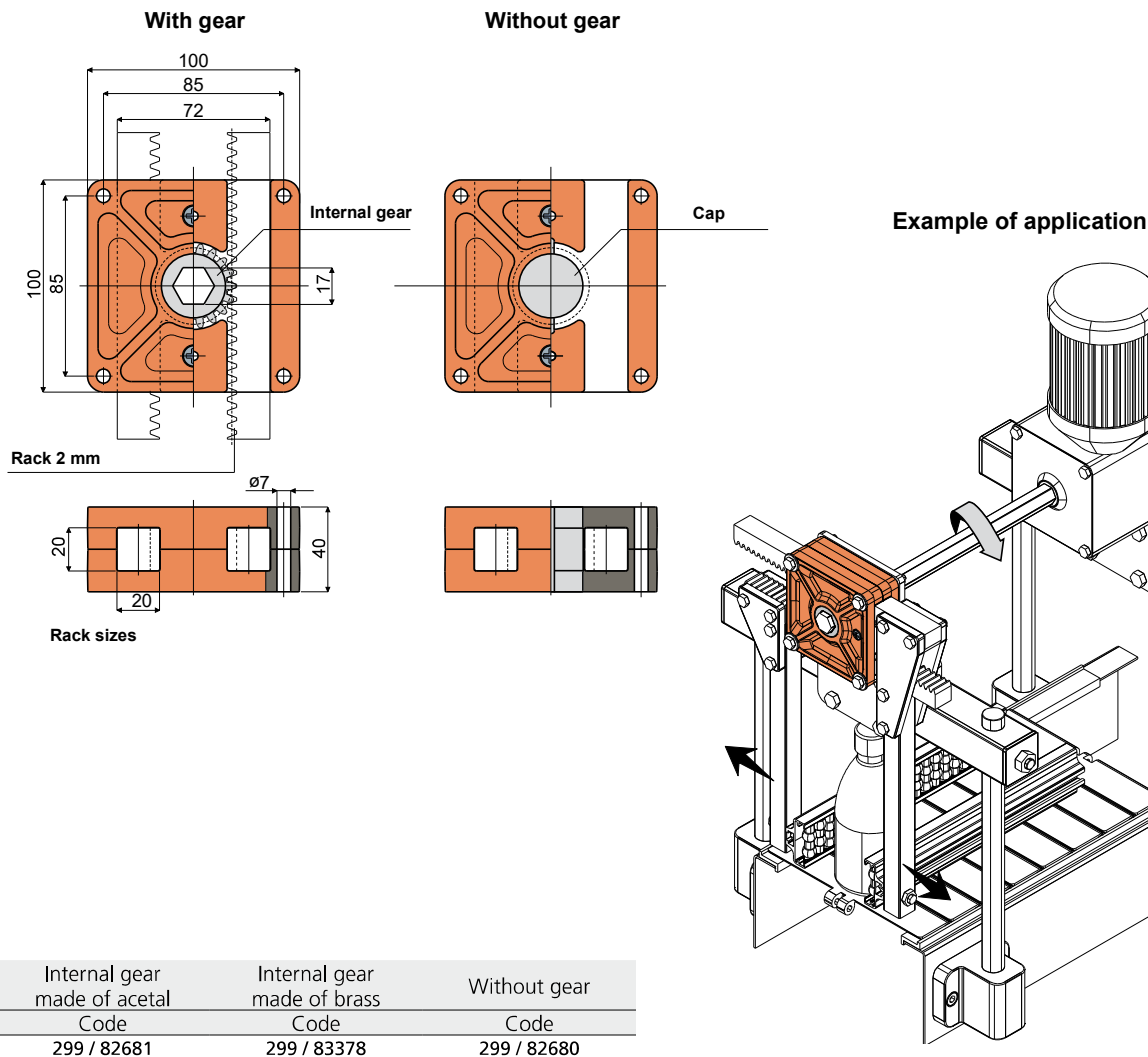
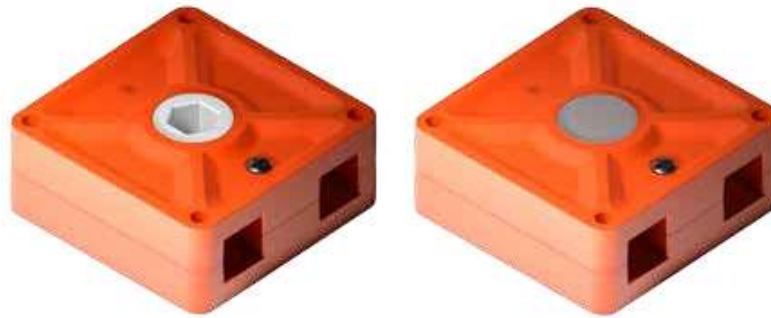

MATERIALS: External body of reducer is made of reinforced polyamide orange colour; self-threading screw is made of stainless steel AISI 304. Available: without internal gear; with internal gear made of acetal, white colour; with internal gear made of brass.

FEATURES: To be used for the cross adjustment of the side guides while changing the size of the conveyed product.

BOX QUANTITY: 24 pieces.

ON REQUEST:

- Reducers: In different colours.
- Box quantity: According to your request.

Accessories for the cross adjustment of the side guides

Part. 331 Reference peg for size changing

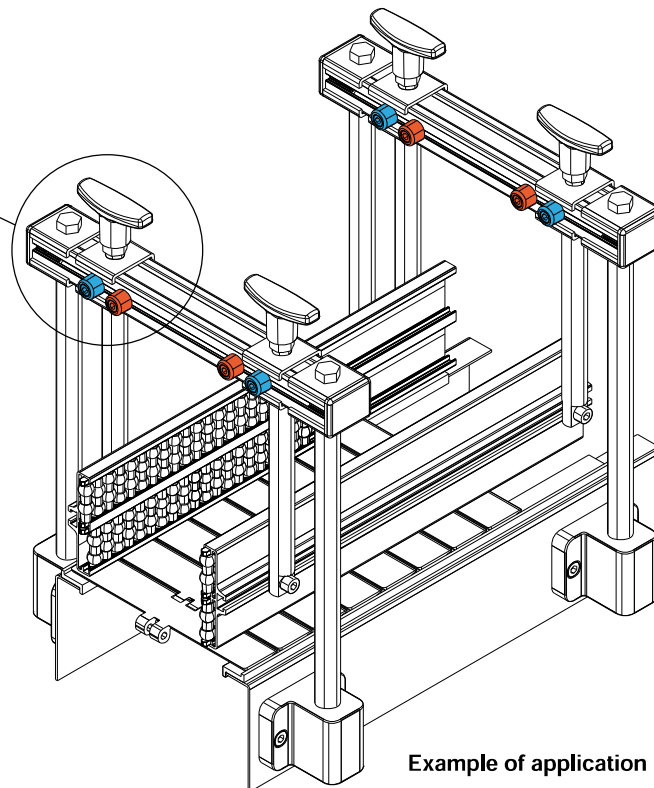
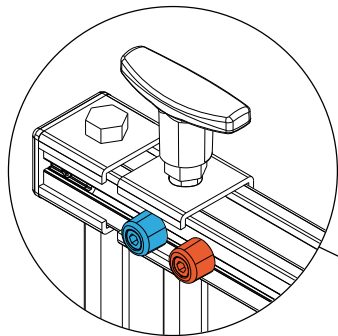
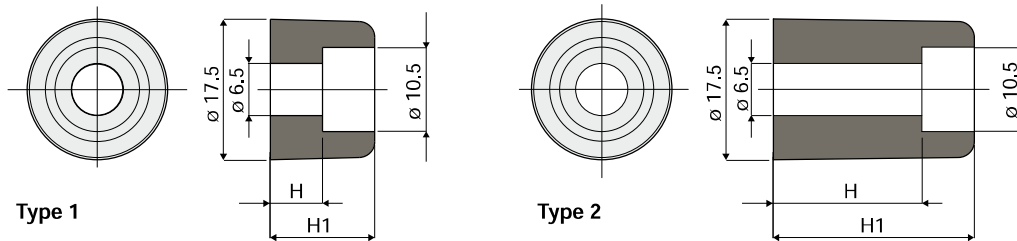

Example of application

Colour	H (mm)	H1 (mm)	Type 1 Code
Black RAL 9005	6,5	13	331 / 83090
White RAL 9001			331 / 83091
Red RAL 3000			331 / 83092
Yellow RAL 1021			331 / 83093
Blue RAL 5015			331 / 83094
Green RAL 6029			331 / 83095
Mustard RAL 1027			331 / 83096
Orange RAL 2004			331 / 83097
Grey RAL 7035			331 / 83098
Pink RAL 3015			331 / 83099
Light blue RAL 6027			331 / 83100
Brown RAL 8001			331 / 83101

Colour	H (mm)	H1 (mm)	Type 2 Code
White RAL 9001	18,5	25	331 / 84479
Red RAL 3000			331 / 84480
Yellow RAL 1021			331 / 84483
Blue RAL 5015			331 / 84482
Green RAL 6029			331 / 84481

MATERIALS: Peg in reinforced polypropylene.

FEATURES: To be used as a reference on the transport guides for size changing.

BOX QUANTITY: 96 pieces.

ON REQUEST:

- Pegs: Can be produced in other colours.
- Box quantity: According to your request.

Accessories for the cross adjustment of the side guides

Spacer for guide rail pin

Part. 352



Type 1

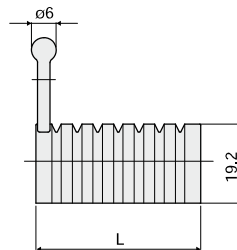
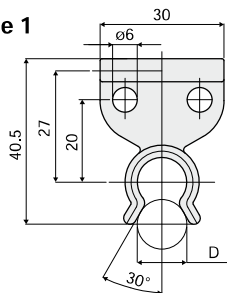

Type 2

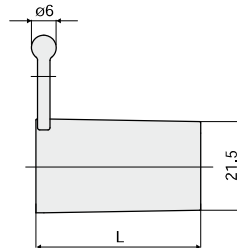
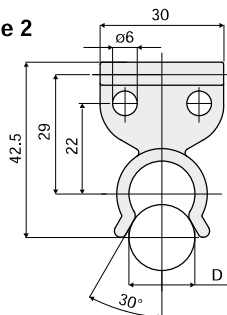

Example of applications

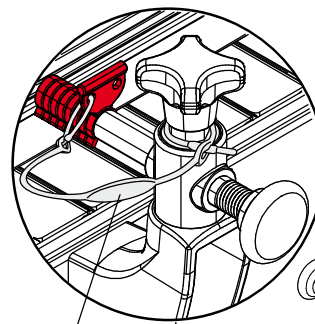
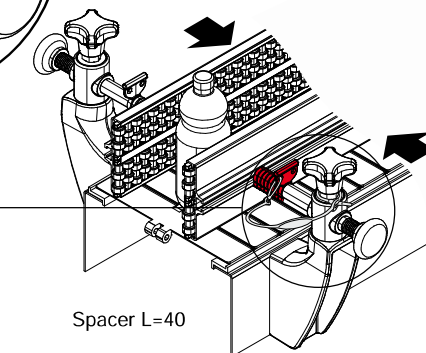
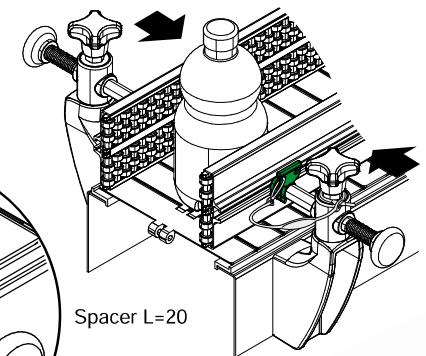
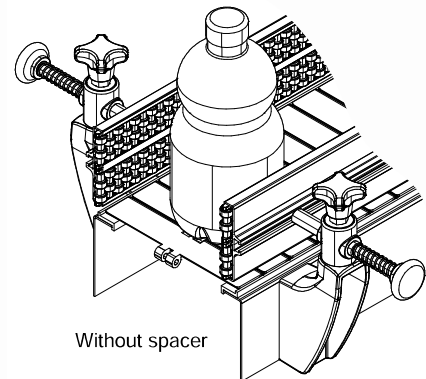

D (mm)	L (mm)	Colour	Type 1 Code
5		White RAL 9001	352 / 83419
10		Red RAL 3000	352 / 83420
15		Black RAL 9005	352 / 83421
20		Green RAL 6029	352 / 83422
25		Yellow RAL 1021	352 / 83423
30		Orange RAL 2004	352 / 83424
35		Blue RAL 5015	352 / 83425
12		White RAL 9001	352 / 83411
		Red RAL 3000	352 / 83412
		Black RAL 9005	352 / 83413
		Green RAL 6029	352 / 83414
		Yellow RAL 1021	352 / 83415
		Orange RAL 2004	352 / 83416
		Blue RAL 5015	352 / 83417
		Grey RAL 7035	352 / 83418

D (mm)	L (mm)	Colour	Type 2 Code
16	40	White RAL 9001	352 / 84444
		Red RAL 3000	352 / 84445
		Green RAL 6029	352 / 84446
		Yellow RAL 1021	352 / 85569
		Blue RAL 5015	352 / 85570

MATERIALS: Spacer in polypropylene.

FEATURES: To be used to adjust the distance between the side guides. Snap-on assembly. Available in different lengths and colours.

BOX QUANTITY: 24 pieces.

ON REQUEST:

- Spacers: Other colours.
- Box quantity: According to your request.