

# TWO-PIECE JUNIOR COUPLINGS

# SDPSI

CROWNED GEAR TEETH  
 CHEMICAL-RESISTANT NYLON  
 NO NEED FOR LUBRICATION  
 ELECTRICALLY ISOLATED

PHONE: 516.328.3300 • FAX: 516.326.8827 • WWW.SDP-SI.COM



**> MATERIAL:**

Nylon

**> OPERATING TEMPERATURE:**

-25°C to +100°C

**> MAX. OPERATING SPEED:**

6000 rpm



SDPSI • SDPSI • SDPSI • SDPSI

Keyway Dimensions								
Bore	6	8	10	12	14	16	18	20
w	2	2	3	4	5	5	6	6
t	1	1	1.4	1.8	2.3	2.3	2.8	2.8

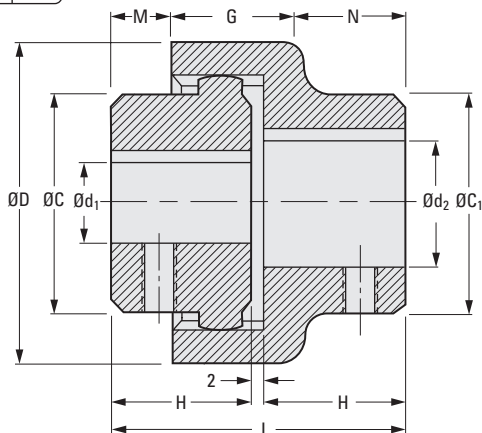

## METRIC COMPONENT

Catalog Number	d <sub>1</sub> Bore	d <sub>2</sub> Bore	C	C <sub>1</sub>	D	H	L	M	N	G	Torque N • m	
											Nom.	Max.
<b>BoWex® Size JR-14</b>												
S5911YMJR140610	6	10	22	25	40	23	48	8	17	23	5	10
S5911YMJR140810	8											
S5911YMJR141010	10											
S5911YMJR141212	12	12	26	26	40	23	48	8	17	23	5	10
S5911YMJR141214	12	14										
S5911YMJR141414	14											
<b>BoWex® Size JR-19</b>												
S5911YMJR191214	12	14	27	29	48	25	52	10	19	23	8	16
S5911YMJR191414	14											
S5911YMJR191614	16											
<b>BoWex® Size JR-24</b>												
S5911YMJR241014	10	14	26	32	52	26	54	9	20	25	12	24
S5911YMJR241214	12											
S5911YMJR241414	14	14	32	32								
S5911YMJR241614	16											
S5911YMJR241820	18											
S5911YMJR242020	20	20	36	36								

**NOTES:** 1. Hub diameters (C, C<sub>1</sub>) are not to exceed dimensions; some smaller bores may have smaller hub diameters.  
 2. M5 set-screw, located 180° opposite from keyway.

